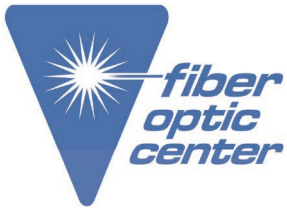

USER GUIDE

**Manufacturer:**

Viavi

Product Name:

Viavi INX 760 Probe Scope Kit with MPO Tips - (Kit 1)

Manufacturer Part Number:

INX-760-KIT1

▶ [Click here for more details on the Viavi INX 760 Probe Scope Kit with MPO Tips - \(Kit 1\)](#)

VIavi

INX™ 700 Series Probe Microscope

User Guide

22174569 R004, Standard

June 2025

Contact the professionals at Fiber Optic Center for a quote or to get more details.

focenter.com • 508-992-6464 | (800) 473-4237 • sales@focenter.com

23 Centre Street • New Bedford, MA 02740 USA

Product data subject to change without notice. FOC last update 1/27/2026.

About this guide	v
Safety instructions	vi
Chapter 1 Introduction	1-1
Variants	1-1
Specifications and regulatory compliance	1-2
Regulatory compliance	1-2
Technical Assistance Center and Knowledge Base	1-3
Chapter 2 Getting started	2-1
Microscope features	2-2
LED states	2-2
Action wheel	2-3
Action trigger	2-3
Powering the microscope ON or OFF	2-4
Powering the microscope ON	2-4
Powering the microscope OFF	2-5
Installing a fiber inspection tip	2-6
Mounting a fiber connector	2-8
Charging the microscope battery	2-9
Replacing the microscope battery	2-10
Chapter 3 Microscope settings	3-1
Navigating the Home screen	3-2
Creating and managing jobs on the microscope	3-5
Creating a job	3-6
Importing job files	3-7
Changing the current job	3-8
Setting the base name and number for a new job	3-9
Deleting a job	3-11
Managing test configuration settings	3-12
Importing profiles	3-13
Deleting profiles	3-14
Managing inspection settings	3-15
Managing system settings	3-16
Updating the microscope software locally	3-18
Chapter 4 Pass/Fail tests and managing results	4-1
Requirements for a Pass/Fail test	4-2
Starting a Pass/Fail test	4-3
Working with Pass/Fail test results	4-4
Overlays	4-4
Test Info	4-4
Pass/Fail test results for MPO and duplex fiber connectors	4-5
Accessing saved Pass/Fail data	4-6
Exporting saved test results	4-7
Appendix A Regulatory compliance	A-1
California Proposition 65	A-2
Federal Communications Commission (FCC)	A-2
Innovation, Science and Economic Development Canada	A-3

Contact the professionals at Fiber Optic Center for a quote or to get more details.

focenter.com • 508-992-6464 | (800) 473-4237 • sales@focenter.com

23 Centre Street • New Bedford, MA 02740 USA

Product data subject to change without notice. FOC last update 1/27/2026.

Korea Communications Commission	A-3
Product Environmental Compliance	A-4
EU REACH	A-5
EU Declaration of Conformity	A-5
EU Radio Equipment Directive	A-5
Additional standards compliance	A-5
China RoHS materials declaration	A-6
Appendix B User Guide revision history	B-1



Contact the professionals at Fiber Optic Center for a quote or to get more details.

focenter.com • 508-992-6464 | (800) 473-4237 • sales@focenter.com

23 Centre Street • New Bedford, MA 02740 USA

Product data subject to change without notice. FOC last update 1/27/2026.

Safety instructions



CAUTION

Turn off the equipment, and disconnect all cables connected to it before moving the equipment or performing maintenance procedures.

ATTENTION

Éteignez l'équipement et débranchez tous les câbles qui y sont connectés avant de déplacer l'équipement ou d'effectuer des procédures de maintenance.



WARNING

- To prevent potential fire or shock hazard, do not expose the equipment to any source of excessive moisture.
- Do not perform any operating or maintenance procedure that is not described in the user documentation. If the equipment is used in a manner not specified by VIAVI, the protection provided by the equipment might be impaired.
- Do not attempt to service this product yourself, as opening or removing covers might expose you to dangerous high-voltage points and other hazards. Refer all servicing to qualified VIAVI service personnel.
- Do not operate any equipment with its covers or panels removed.

AVERTISSEMENT

- Pour éviter tout risque d'incendie ou d'électrocution, n'exposez pas l'équipement à une source d'humidité excessive.
- N'effectuez aucune opération ou procédure de maintenance qui n'est pas décrite dans la documentation utilisateur. Si l'équipement est utilisé d'une manière non spécifiée par VIAVI, la protection fournie par l'équipement peut être altérée.
- N'essayez pas de réparer ce produit vous-même, car l'ouverture ou le retrait des panneaux latéraux peut vous exposer à des points haute tension dangereux et à d'autres dangers. Confiez tous les travaux d'entretien au personnel de service qualifié de VIAVI.
- N'utilisez aucun équipement dont les panneaux latéraux ont été retirés.

Note: See also “Regulatory compliance” on page A-1.

Contact the professionals at Fiber Optic Center for a quote or to get more details.

focenter.com • 508-992-6464 | (800) 473-4237 • sales@focenter.com

23 Centre Street • New Bedford, MA 02740 USA

1 Introduction

INX 700 Series Inspection Probe Microscopes offer unparalleled efficiency in ensuring pristine single-fiber, duplex-fiber, or multifiber connections.

Optimized for field use and VIAVI TPA™ (Test Process Automation) enabled, INX 700 Series microscopes enable automation of every step of the inspection process, including test set up, tip configuration, image panning and focus, end-face analysis testing, and data storage.

Operators can use an INX 700 Series microscope autonomously. Microscopes that support wireless connectivity can be connected to a local device, such as a mobile device or PC, via USB or wireless connection, with the VIAVI Mobile Tech app serving as the bridge between the microscope and the cloud.

Figure 1-1: INX 700 Series



Variants

Variant	Description
INX 750	INX 750 Probe Microscope
INX 760	INX 760 Probe Microscope

Contact the professionals at Fiber Optic Center for a quote or to get more details.

focenter.com • 508-992-6464 | (800) 473-4237 • sales@focenter.com

23 Centre Street • New Bedford, MA 02740 USA

Product data subject to change without notice. FOC last update 1/27/2026.

Specifications and regulatory compliance

Table 1-1: INX 700 Series Probe Microscope specifications

Parameter	Specification
Display	320 x 240-pixel (2.4") IPS color backlit touch screen
Status indicators	<ul style="list-style-type: none"> • LED ring • Speaker
Power supply	5V/2.1A USB AC adapter
Battery	Li-ion 18.15 Wh (field replaceable)
Charging modes	<ul style="list-style-type: none"> • USB2.0 in 500mA and 1.5A modes • USB-C Power Delivery (PD), 500mA, 1.5A, and 3A modes
USB port	1x USB-C
Wireless connectivity Note: INX 760 Probe Microscope only	Singleband 2.4 GHz <ul style="list-style-type: none"> • Bluetooth® 5.2 BLE • Wi-Fi 802.11b/g/n
Mounting point	¼" diameter, 20 threads per inch (¼"-20) socket
Operating temperature	0 to 40°C (32 to 104°F)
Operating humidity	0 to 90% non-condensing
Storage temperature	-20 to 60°C (-4 to 140°F)
Dimensions (L x W x H)	<ul style="list-style-type: none"> • Without inspection tip: 253 x 191 x 60 mm (9.9 x 7.5 x 2.4 in) • With LC inspection tip: 275 x 191 x 60 mm (10.8 x 7.5 x 2.4 in)
Weight (without inspection tip)	0.665 kg (1.5 lb)
Inspection tips	Simplex, Duplex, or Multifiber; stainless steel with threaded mounting nut; integrated auto-identification technology; tether point (lanyard sold separately)

Regulatory compliance

To access regulatory compliance information on the microscope, select **Main Menu > System Settings > System Info > Regulatory Info**.

Figure 1-2: Accessing regulatory compliance information

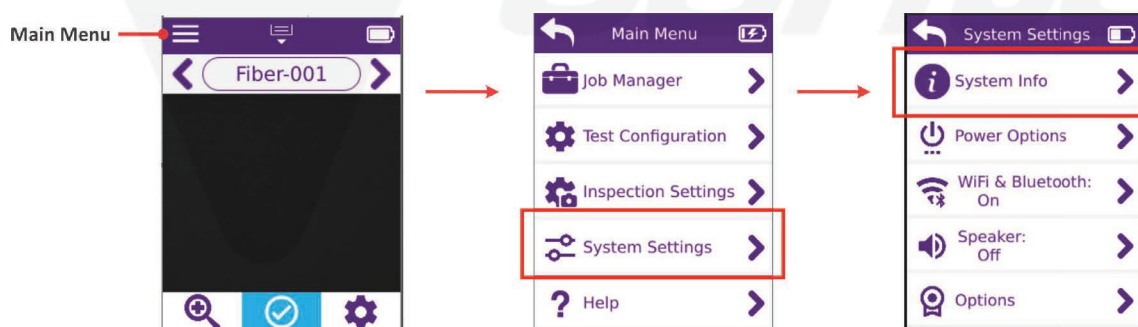

Contact the professionals at Fiber Optic Center for a quote or to get more details.

focenter.com • 508-992-6464 | (800) 473-4237 • sales@focenter.com

23 Centre Street • New Bedford, MA 02740 USA

2 Getting started

This section covers the following information:

- “Microscope features” on page 2-2
- “Powering the microscope ON or OFF” on page 2-4
- “Installing a fiber inspection tip” on page 2-6
- “Mounting a fiber connector” on page 2-8
- “Charging the microscope battery” on page 2-9
- “Replacing the microscope battery” on page 2-10

*fiber
optic
center*

Contact the professionals at Fiber Optic Center for a quote or to get more details.

focenter.com • 508-992-6464 | (800) 473-4237 • sales@focenter.com

23 Centre Street • New Bedford, MA 02740 USA

Product data subject to change without notice. FOC last update 1/27/2026.

Microscope features



LED states

State	LED Ring	Charging LED
Off	<ul style="list-style-type: none"> Microscope powered OFF Microscope powered ON, no test in progress 	<ul style="list-style-type: none"> Microscope powered OFF Battery charger not connected
Orange	—	Battery charging, microscope powered OFF
Blue	—	Microscope powered ON
Purple (circulating)	Test in progress	—
Red	Test failed	—
Green	Test passed	Battery fully charged
Blue Orange (flashing)	—	Fully discharged battery charging, microscope powered ON (Power OFF microscope until battery charged)

Contact the professionals at Fiber Optic Center for a quote or to get more details.

focenter.com • 508-992-6464 | (800) 473-4237 • sales@focenter.com

23 Centre Street • New Bedford, MA 02740 USA

Action wheel

Depending on the type of fiber connector installed on the inspection tip, the Action wheel enables you to either manually focus the Live image of a fiber connector displayed on the **Home** screen or pan across it.

Fiber connector type	Rotate the Action wheel to...
Simplex or Duplex	Manually focus the Live image of the fiber end face
MPO	Manually pan across the Live image of the fiber end face

Action trigger

The Action trigger operates via either short press or long press (i.e., press and hold).

Do the following...	To...
Short press the Action trigger	<ul style="list-style-type: none">Start a Pass/Fail test while Auto-test system setting is set to On AutoFocus (see "Managing system settings" on page 3-16)Autofocus the fiber image displayed in Live viewReturn to the Home screen from any other screen
Long press the Action trigger	Start a Pass/Fail test

Contact the professionals at Fiber Optic Center for a quote or to get more details.

focenter.com • 508-992-6464 | (800) 473-4237 • sales@focenter.com

23 Centre Street • New Bedford, MA 02740 USA

Product data subject to change without notice. FOC last update 1/27/2026.

Powering the microscope ON or OFF

Powering the microscope ON

Step 1 Press and hold the Power button for two (2) seconds.

Step 2 Note the following sequence:

- The touchscreen lights, and the start-up screen appears after a few seconds.
- The charging LED lights blue.
- The objective lens of the microscope might move to automatically adjust its position.
- The **Home** screen appears on the touchscreen after the initialization process is completed.

The following image shows the **Home** screen that displays when an inspection tip is installed on the microscope, but no fiber is connected to the tip.

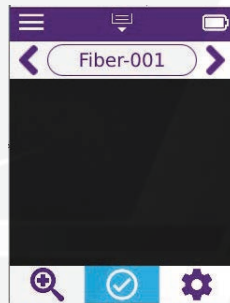

While an inspection tip is installed on the device, the fiber illumination LED emits a blue light from the end of the objective lens.

Note: To protect the objective lens from dust and debris, always place the safety cap on the inspection tip when the microscope is not in use. For information, see, "[Installing a fiber inspection tip](#)" on page 2-6.

— End —

Contact the professionals at Fiber Optic Center for a quote or to get more details.

focenter.com • 508-992-6464 | (800) 473-4237 • sales@focenter.com

23 Centre Street • New Bedford, MA 02740 USA

Powering the microscope OFF

- Press and hold the Power button until the touchscreen turns off.

The fiber illumination LED and the charging LED turn off after a few seconds.

Note: You can set an automatic power OFF setting for the microscope. See “[Managing system settings](#)” on [page 3-16](#).

— End —



Contact the professionals at Fiber Optic Center for a quote or to get more details.

focenter.com • 508-992-6464 | (800) 473-4237 • sales@focenter.com

23 Centre Street • New Bedford, MA 02740 USA

Product data subject to change without notice. FOC last update 1/27/2026.

Installing a fiber inspection tip

Step 1 Remove the inspection tip installed on the microscope:

- i. Holding the microscope securely, rotate the inspection tip collar to fully loosen it.
- ii. Carefully pull the tip away from the microscope, ensuring that the tip does not come into contact with the objective lens.

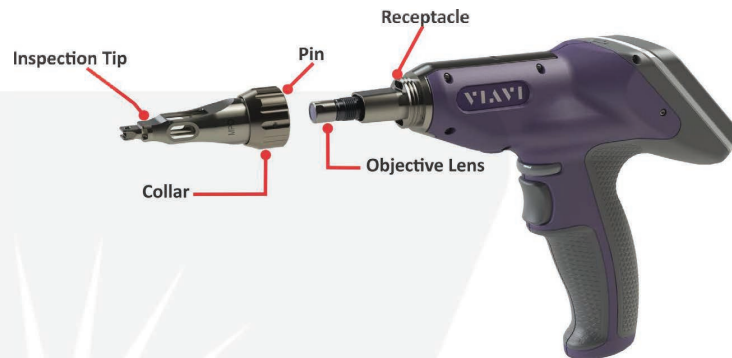

- iii. Install the safety cap at the back of the inspection tip, place the tip in a dust-proof container, and store it in an accessible location.

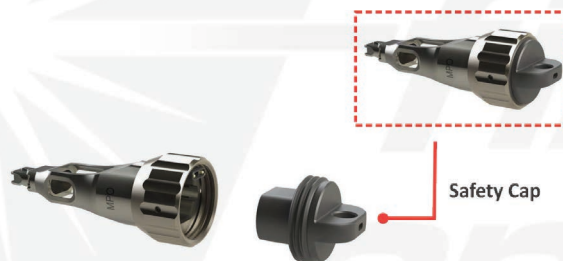

Step 2 If the microscope is powered on, note the following:

- The fiber illumination LED turns off.
- The **Home** screen indicates that no tip is attached to the microscope, and the Tool tray is disabled.

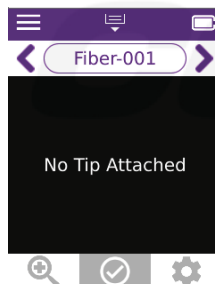

Contact the professionals at Fiber Optic Center for a quote or to get more details.

focenter.com • 508-992-6464 | (800) 473-4237 • sales@focenter.com

23 Centre Street • New Bedford, MA 02740 USA

Step 3 Install the required inspection tip:

- i. If present, carefully loosen and remove the inspection tip cap cover from back of the tip, and place it in a dust-free container.
- ii. Align the pin at the rear of the inspection tip with the receptacle on the microscope.
- iii. Carefully position the inspection tip onto the microscope, ensuring that the tip does not come into contact with the objective lens, and that the pin is inserted in the receptacle.
- iv. Thread the collar of the tip, and rotate it to secure it to the microscope. Do not overtighten the collar.

Important: Ensure that the collar is properly threaded and secured to the microscope.

Step 4 If the microscope is powered on, note the following:

- The objective lens might move to adjust to the correct position for the newly installed tip.

Note: You can confirm that the microscope has detected the type of tip installed by accessing Test Configuration settings. For information, see “[Navigating the Home screen](#)” on page 3-2.

- The fiber illumination LED emits a blue light from the end of the objective lens.

Note: Place the dust cover onto the inspection tip to keep the objective lens free of dust and debris while the microscope is not in use.



— End —

Contact the professionals at Fiber Optic Center for a quote or to get more details.

focenter.com • 508-992-6464 | (800) 473-4237 • sales@focenter.com

23 Centre Street • New Bedford, MA 02740 USA

Mounting a fiber connector

- Step 1 Power ON the microscope, and, if required, short press the Action trigger to return to the **Home** screen.
- Step 2 Ensure that the fiber inspection tip required for the Pass/Fail application is installed on the microscope.
- Step 3 Thoroughly clean the fiber connector, and mount it onto the inspection tip.

For a bulkhead connector, ensure that the connector is correctly aligned with the key on the inspection tip.



A Live view of the fiber end face appears on the **Home** screen.

Note: If **Auto-focus On Insert** is enabled, the microscope will automatically adjust the focus quality of Live view.

- Step 4 Use any of the available tools for viewing the fiber end face on the **Home** screen, and refer to the focus meter if shown (see “[Navigating the Home screen](#)” on page 3-2) to ensure that the focus quality of Live view is suitable for inspection:
- Action trigger: Short press to automatically adjust the focus quality of Live view.
 - Action wheel: Rotate to manually adjust the focus quality of Live view with simplex and duplex tips.
 - Magnification High/Low: See “[Navigating the Home screen](#)” on page 3-2.
 - Panning: See “[Navigating the Home screen](#)” on page 3-2.

— End —

Contact the professionals at Fiber Optic Center for a quote or to get more details.

focenter.com • 508-992-6464 | (800) 473-4237 • sales@focenter.com

23 Centre Street • New Bedford, MA 02740 USA

Charging the microscope battery

- Step 1 Connect the USB connector of a suitable charger to the USB-C port on the microscope.
- Step 2 Connect the charger to an appropriate power source.
- Step 3 When the battery is charged (see “LED states” on page 2-2), disconnect the charger from the power source and then from the microscope.
- Step 4 Store the charger in an accessible location.

— End —

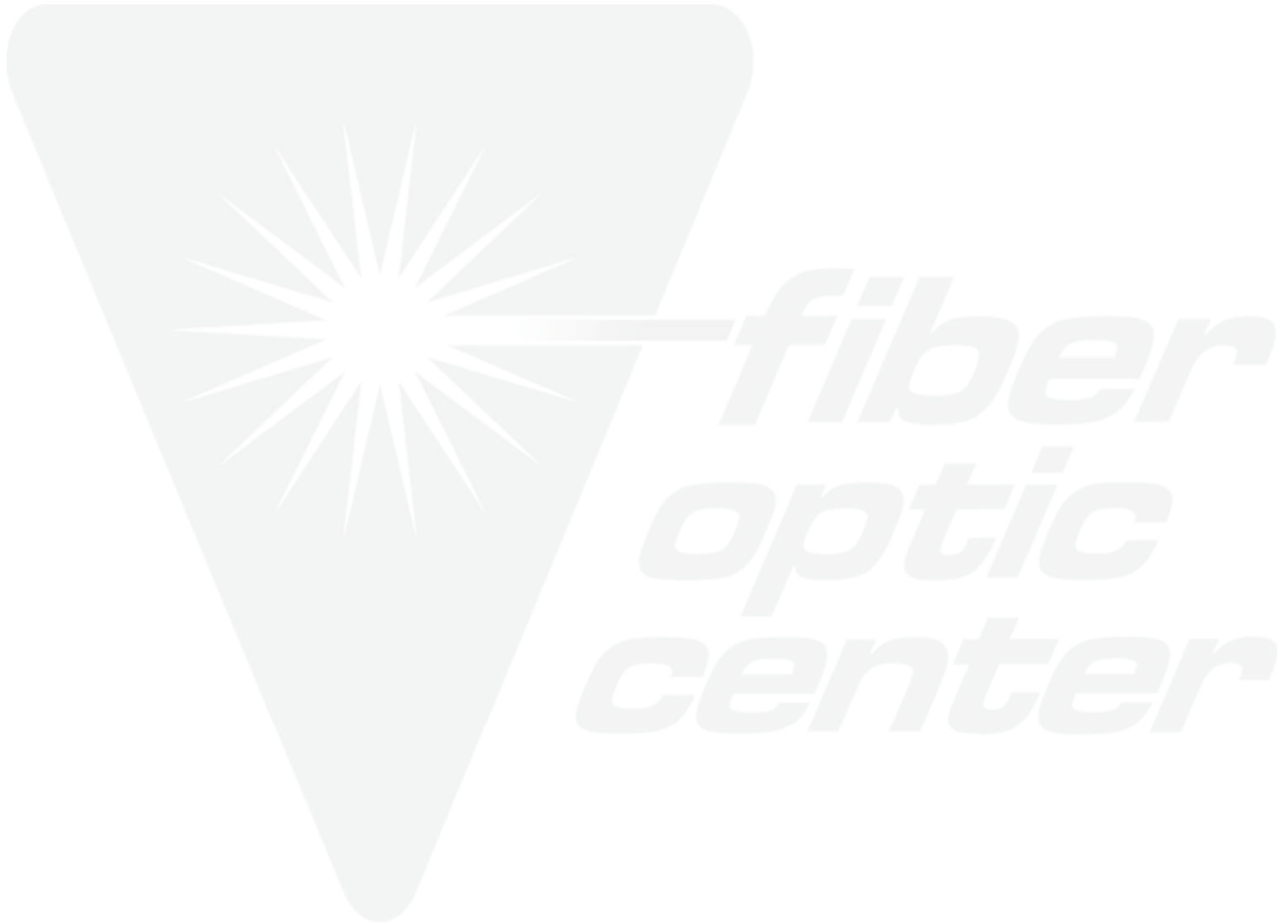

Contact the professionals at Fiber Optic Center for a quote or to get more details.

focenter.com • 508-992-6464 | (800) 473-4237 • sales@focenter.com

23 Centre Street • New Bedford, MA 02740 USA

Product data subject to change without notice. FOC last update 1/27/2026.

Replacing the microscope battery

Important: Use only the VIAVI-supplied battery.

- Step 1 Power OFF the microscope (see “Powering the microscope OFF” on page 2-5).
- Step 2 Holding the microscope securely, remove the battery cover.
- Step 3 Carefully slide the battery far enough out of the receptacle to disconnect the battery cable connector from the jack, and then fully remove the battery from the receptacle.

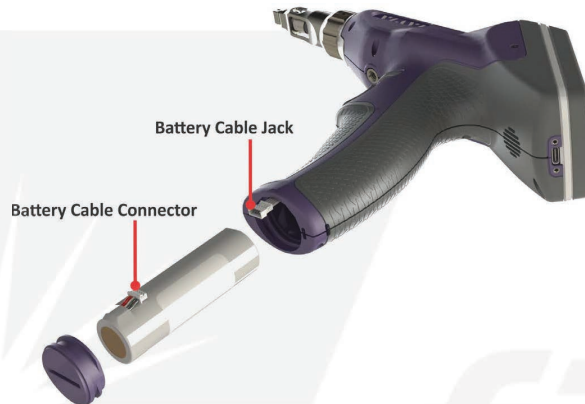

Important: Dispose of the used battery according to local requirements.

- Step 4 Carefully insert the replacement battery into the receptacle, and connect the battery cable to the jack. The microscope automatically powers ON.
- Step 5 Replace and secure the battery cover. Do not overtighten the cover.

— End —

Contact the professionals at Fiber Optic Center for a quote or to get more details.

focenter.com • 508-992-6464 | (800) 473-4237 • sales@focenter.com

23 Centre Street • New Bedford, MA 02740 USA



3 Microscope settings

This section covers the following information:

- “Navigating the Home screen” on page 3-2
- “Creating and managing jobs on the microscope” on page 3-5
- “Managing test configuration settings” on page 3-12
- “Managing inspection settings” on page 3-15
- “Managing system settings” on page 3-16
- “Updating the microscope software locally” on page 3-18

*fiber
optic
center*

Contact the professionals at Fiber Optic Center for a quote or to get more details.

focenter.com • 508-992-6464 | (800) 473-4237 • sales@focenter.com

23 Centre Street • New Bedford, MA 02740 USA

Product data subject to change without notice. FOC last update 1/27/2026.

Navigating the Home screen

Note: Short press the Action trigger on the microscope to return to the **Home** screen from any other screen.

Figure 3-1: Home screen

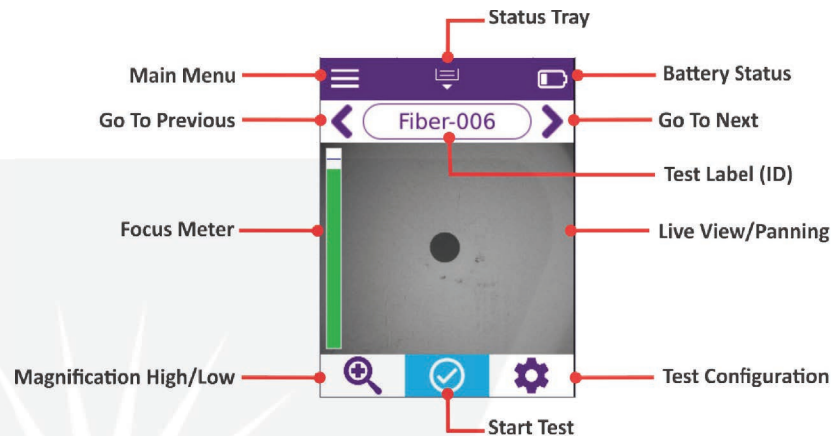

Table 3-1: Home screen menus and tools

Tool/Menu	Description
Main Menu options	Job Manager Organize and access Pass/Fail data saved the to microscope. See “ Creating and managing jobs on the microscope ” on page 3-5.
	Test Configuration Access test configuration settings, such type of inspection tip, optical setting for tip, and analysis profile options. See “ Managing test configuration settings ” on page 3-12.
	Inspection Settings See “ Managing inspection settings ” on page 3-15.
	System Settings Access system settings for the microscope, such as wireless connectivity, automatic power OFF options, and read-only system information. See “ Managing system settings ” on page 3-16.
	Help Access a QR code that provides access to the following functions: <ul style="list-style-type: none">• Scan the code to access to the latest version of microscope documentation.• Tap the code to generate diagnostic files (*.diag) for troubleshooting microscope issues. The generated files are available on the VIAVI Mobile Tech app.

Contact the professionals at Fiber Optic Center for a quote or to get more details.

focenter.com • 508-992-6464 | (800) 473-4237 • sales@focenter.com

23 Centre Street • New Bedford, MA 02740 USA

Product data subject to change without notice. FOC last update 1/27/2026.

Table 3-1: Home screen menus and tools (continued)

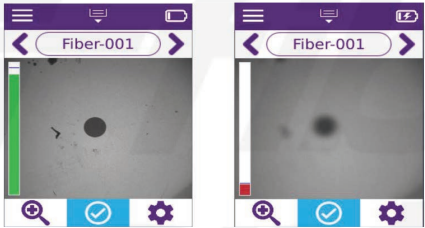
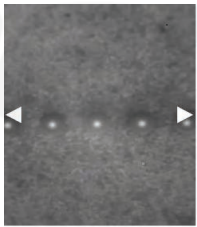
Tool/Menu	Description
Status Tray	<p>Swipe down to access the following information and tools:</p> <ul style="list-style-type: none"> • Speaker: Set the speaker ON/OFF status. • Job Name: Name of the current job to which saved test results are added. • Create New Job: Select to access the Create New Job screen of the Job Manager. See “Creating and managing jobs on the microscope” on page 3-5 for more information. <p>Notes:</p> <ul style="list-style-type: none"> • You can also set the speaker ON/OFF status via the Inspection Settings screen. For information, see “Managing inspection settings” on page 3-15. • Swipe up to close the menu.
Battery Status	<p>Battery status indicator</p> <p>Note: See “Managing system settings” on page 3-16 for information about accessing additional battery status information.</p>
Go To Previous/Go To Next	Select to scroll to a test ID for the current job.
Focus Meter	<p>Color meter that indicates whether the quality of the live fiber image is suitable for inspection. Green indicates that the focus quality is suitable for inspection; red, that the focus quality is not suitable.</p>  <p>Note: By default, the focus meter is hidden. For information about showing/hiding the focus meter, see “Managing inspection settings” on page 3-15.</p>
Live View/Panning	<p>Live view of the fiber end face mounted on the fiber inspection tip.</p> <p>Tap to display the Panning tools, and then select a tool to pan to the left or right across the fiber end face.</p>  <p>Notes:</p> <ul style="list-style-type: none"> • Panning tools are available only while a duplex or MPO fiber connector is mounted on the inspection tip. • Tap Live view to hide the Panning tools and return to the Home screen.

Contact the professionals at Fiber Optic Center for a quote or to get more details.

focenter.com • 508-992-6464 | (800) 473-4237 • sales@focenter.com

23 Centre Street • New Bedford, MA 02740 USA

Table 3-1: Home screen menus and tools (continued)

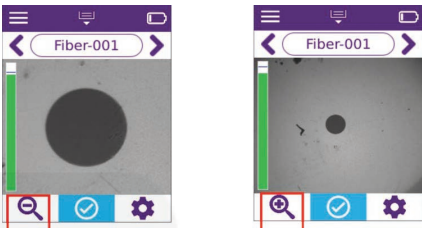
Tool/Menu	Description
Magnification High/Low	<p>Select to increase/decrease magnification of the live fiber image.</p>  <p>Note: Magnification tools are available only while a simplex or duplex fiber connector is mounted on the inspection tip.</p>
Start Test	See “Pass/Fail tests and managing results” on page 4-1.
Test Configuration	Quick access to Test Configuration settings also available via the Main Menu. See “Managing test configuration settings” on page 3-12.

Contact the professionals at Fiber Optic Center for a quote or to get more details.

focenter.com • 508-992-6464 | (800) 473-4237 • sales@focenter.com

23 Centre Street • New Bedford, MA 02740 USA

Product data subject to change without notice. FOC last update 1/27/2026.

Creating and managing jobs on the microscope

The **Job Manager** tool enables you to manage Pass/Fail data that is saved to the current (active) job on the INX 700 Series microscope, facilitating access to data when required. You can create and add multiple jobs to the **Job Manager**; however, only one job can be active on the microscope at any time.

Each job created with the **Job Manager** tool on the microscope has a unique ID that is comprised of a base name and a three-digit number (for example, Job-001). Saved data is automatically added to the current job and assigned a unique test label (ID) associated with the job. The test ID is also comprised of a base name and a three-digit number (for example, Fiber-001).

Note: If the **Auto-increment** inspection setting is set to **On Save**, the test ID will automatically increment to the next available number when another set of data is saved to the same job. For more information, see [“Managing inspection settings” on page 3-15](#).

Use the **Job Manager** tool for any of the following tasks:

- [“Creating a job” on page 3-6](#)
- [“Changing the current job” on page 3-8](#)
- [“Setting the base name and number for a new job” on page 3-9](#)
- [“Deleting a job” on page 3-11](#)

You can also add jobs to the **Job Manager** by importing job files that were exported from StrataSync™ to a USB-C thumb drive (see [“Importing job files” on page 3-7](#)). You can use and manage these jobs on the microscope as you would jobs created on the microscope.

Notes:

- For information about accessing Pass/Fail test results saved to a job, see [“Accessing saved Pass/Fail data” on page 4-6](#).
- Jobs created with the VIAVI Mobile Tech app or deployed to the app from StrataSync can be downloaded to the INX 700 Series microscope. You can use and manage these jobs on the microscope as you would jobs created on the microscope.

Contact the professionals at Fiber Optic Center for a quote or to get more details.

focenter.com • 508-992-6464 | (800) 473-4237 • sales@focenter.com

23 Centre Street • New Bedford, MA 02740 USA

Creating a job

The microscope enables you to quickly create a job that uses the same base name as the last job created. To ensure that the job ID is unique, the number of the ID is automatically incremented to the next available.

Note: Although you can use the same base name for multiple job IDs, the number assigned to it cannot be reused. Therefore, the job ID number automatically increments to the next available number when you begin creating a job that reuses a base name. For information about creating a job with a new base name, see “Setting the base name and number for a new job” on page 3-9.

Step 1. Select **Job Manager** on the **Main Menu**, and then select **Create New Job**.

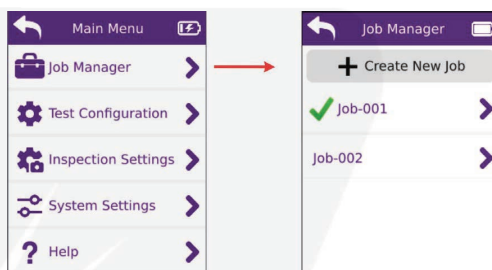

The **Job Manager** contains a list of jobs available on the microscope. The current job appears at the top of the list with a check mark beside the job ID.

Step 2. Select **Create New Job**.

Step 3. On the **Create Job** screen, select **Create** to create a job using the **Job Name** and **Test Label Scheme** provided by the microscope.



The new job is added to the **Job Manager** and automatically set as the current job.

Step 4. Short press the Action trigger to return to the **Home** screen.

Note: You can also access the **Create Job** screen by selecting **Start New Job** on the **Status Tray** on the **Home** screen.

— End —

Contact the professionals at Fiber Optic Center for a quote or to get more details.

focenter.com • 508-992-6464 | (800) 473-4237 • sales@focenter.com

23 Centre Street • New Bedford, MA 02740 USA

Product data subject to change without notice. FOC last update 1/27/2026.

Importing job files

Job files (*.json) created in StrataSync and then exported to a USB-C thumb drive can be imported to the microscope. You can use and manage these jobs on the microscope as you would jobs created on the microscope.

Notes:

- The thumb drive must be formatted as either exFAT, FAT16, or FAT32.
- The import operation will automatically import all job files available on the thumb drive.

Step 1. Ensure that the required job files are available on the thumb drive.

Name	Date modified	Type	Size
Job-128.job.json	4/11/2024 2:51 PM	JSON File	3 KB
Job-520.job.json	4/11/2024 2:51 PM	JSON File	3 KB

Step 2. Connect the thumb drive to the microscope.

The **USB** screen appears. When job files are available on the thumb drive, the **Job Import** option is available.

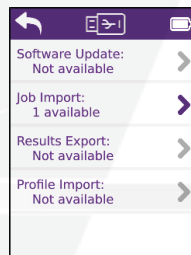

Step 3. Select **Import**, and then select **Yes** to confirm the operation.

Available job files are imported to the microscope and added to the **Job Manager**.

Step 4. Access the **Job Manager** to confirm that the imported job files are available.

— End —

Contact the professionals at Fiber Optic Center for a quote or to get more details.

focenter.com • 508-992-6464 | (800) 473-4237 • sales@focenter.com

23 Centre Street • New Bedford, MA 02740 USA

Product data subject to change without notice. FOC last update 1/27/2026.

Changing the current job

Step 1. Select **Job Manager** on the **Main Menu**.

On the **Job Manager** screen, the ID of the current job is indicated by a check mark and appears at the top of the list.

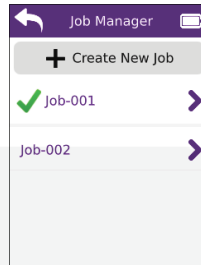

Step 2. Select a job ID in the list, and then select **Select as Current Job** on the **Job Info** screen.

The **Select as Current Job** label changes to **Current Job**.

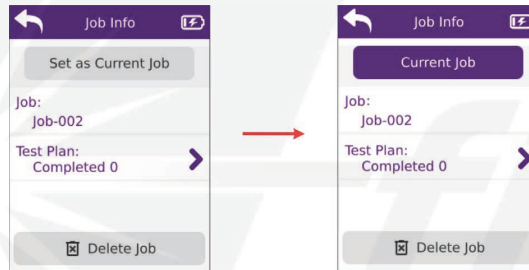

Step 3. Select **Back** to return to the **Job Manager** screen.

The selected job ID appears at the top of the list with a check mark beside it.

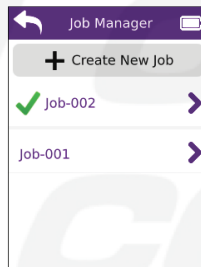

Step 4. Short press the Action trigger to return to the **Home** screen.

— End —

Contact the professionals at Fiber Optic Center for a quote or to get more details.

focenter.com • 508-992-6464 | (800) 473-4237 • sales@focenter.com

23 Centre Street • New Bedford, MA 02740 USA

Setting the base name and number for a new job

Step 1. Select **Job Manager** on the **Main Menu**, and then select **Create New Job**.

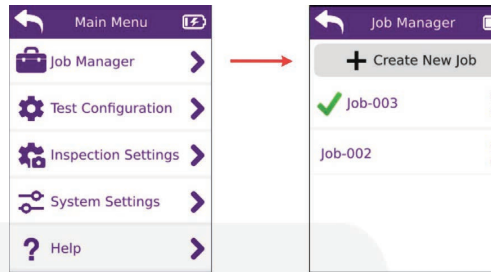

Step 2. On the **Create Job** screen, select one of the following options:

- **Job Name**
- **Test Label Scheme**

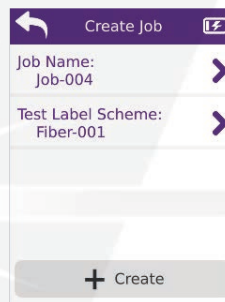

Step 3. Do any of the following:

- Select **Base Name**, enable an option in the list of base names, and then select **Back**.
- Set the **Number** for the option by selecting - or + to scroll to an unused number.

Note: The following images show the sequence for setting the job name.

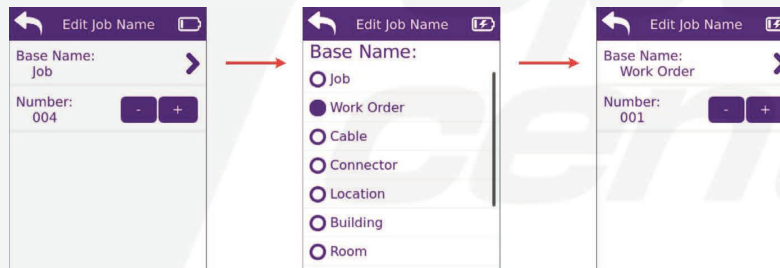

Note: The message Job already exists! appears when you scroll to a number that is already in use.

Contact the professionals at Fiber Optic Center for a quote or to get more details.

focenter.com • 508-992-6464 | (800) 473-4237 • sales@focenter.com

23 Centre Street • New Bedford, MA 02740 USA

- Step 4. Select **Back** to return to the **Create Job** screen, and repeat [Step 2](#) and [Step 3](#) for the other option if required.
- Step 5. Select **Create** to create the job.
- The job is added to the **Job Manager** and is automatically set as the current job (as indicated by the check mark beside the job ID).
- Step 6. Short press the Action trigger to return to the **Home** screen.

— End —

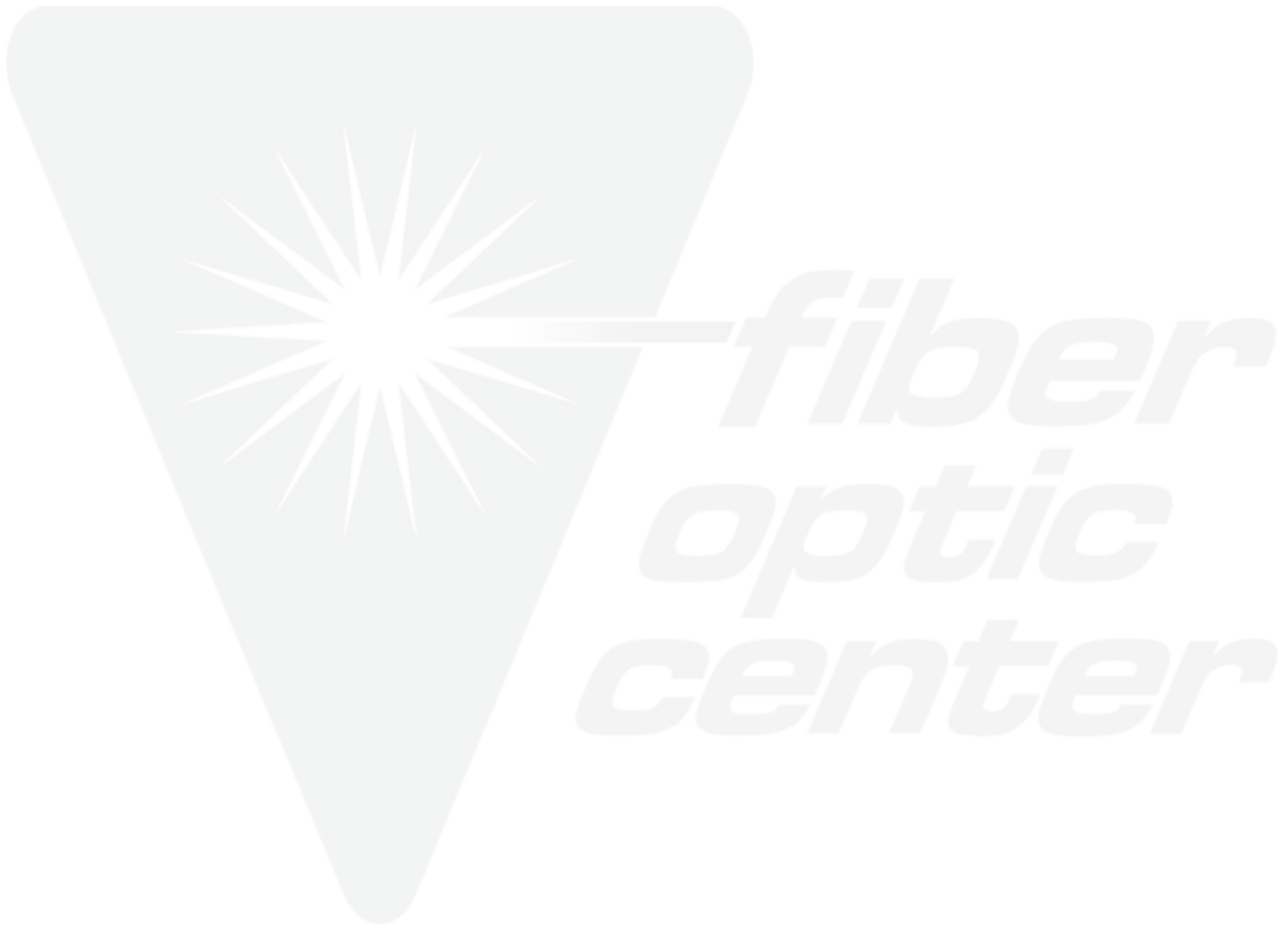

Contact the professionals at Fiber Optic Center for a quote or to get more details.

focenter.com • 508-992-6464 | (800) 473-4237 • sales@focenter.com

23 Centre Street • New Bedford, MA 02740 USA

Product data subject to change without notice. FOC last update 1/27/2026.

Deleting a job

Important: Deleting a job removes all the data it contains from the microscope. Before deleting a job, ensure that all required data has been downloaded to the VIAVI Mobile Tech app.

- Step 1. Select **Job Manager** on the **Main Menu**.
- Step 2. On the **Job Manager** screen, select a job ID in the list.
- Step 3. On the **Job Info** screen, select **Delete Job**.

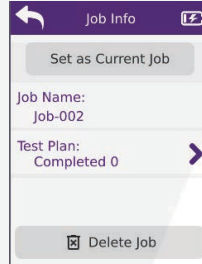

- Step 4. Click **OK** to confirm the operation and return to the **Job Manager** screen.
- Step 5. Short press the Action trigger to return to the **Home** screen.

— End —

Contact the professionals at Fiber Optic Center for a quote or to get more details.

focenter.com • 508-992-6464 | (800) 473-4237 • sales@focenter.com

23 Centre Street • New Bedford, MA 02740 USA

Product data subject to change without notice. FOC last update 1/27/2026.

Managing test configuration settings

- Select **Test Configuration** on the **Main Menu**.

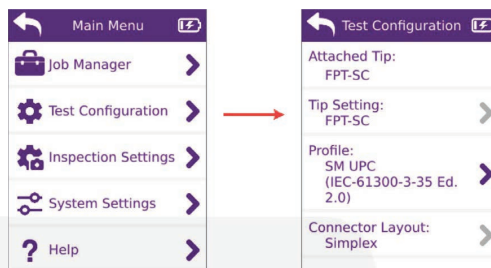

Table 3-2: Test Configuration settings

Settings	Description
Attached Tip	Type of fiber inspection tip installed on the microscope.
Tip Setting	Optical setting for the Pass/Fail test of the fiber connector mounted on the inspection tip. The optical setting defines lighting and sizing calibration applied during inspection. Note: Read-only when only a single setting is available.
Profile	Access preconfigured analysis profiles available on the microscope. Profiles define the Pass/Fail thresholds for the fiber type mounted on the inspection tip. Each preconfigured profile matches the PASS/FAIL criteria of an IEC visual inspection standard; for example, IEC 61300-3-35. Notes: <ul style="list-style-type: none"> • A profile specifies the fiber type, analysis sensitivity, the zones of interest within the fiber (typically starting with the fiber core and radiating out from there) and the criteria for failure within those zones. • You can import and use custom profiles created with the FiberChekPro™ software application (see “Importing profiles” on page 3-13). • You can delete one or more profiles available on the microscope when no longer required (see “Deleting profiles” on page 3-14).
Connector Layout	Fiber type mounted on inspection tip: <ul style="list-style-type: none"> • Simplex • Type Duplex (Where <i>Type</i> refers to the fiber type; for example LC) • MPO <i>N</i> (where <i>N</i> refers to the number of fibers in the cable) Note: Read-only when only single setting is available.

Contact the professionals at Fiber Optic Center for a quote or to get more details.

focenter.com • 508-992-6464 | (800) 473-4237 • sales@focenter.com

23 Centre Street • New Bedford, MA 02740 USA

Importing profiles

Analysis profile files (*.pro) exported from the FiberChekPRO software application and then saved to a USB-C thumb drive can be imported to the microscope.

Notes:

- The thumb drive must be formatted as either exFAT, FAT16, or FAT32.
- The import operation will automatically import all profiles files available on the thumb drive.

Step 1. Ensure that the required profile files are available on the thumb drive.

Step 2. Connect the thumb drive to the microscope.

The **USB** screen appears. When profile files are available on the thumb drive, the **Profile Import** option is available.

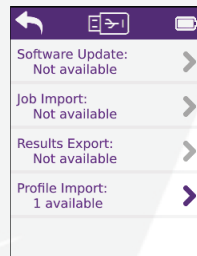

Step 3. Select **Profile Import**, and then select **Yes** to confirm the operation.

Available profile files are imported to the microscope and appear in the list of available profiles.

— End —

Contact the professionals at Fiber Optic Center for a quote or to get more details.

focenter.com • 508-992-6464 | (800) 473-4237 • sales@focenter.com

23 Centre Street • New Bedford, MA 02740 USA

Product data subject to change without notice. FOC last update 1/27/2026.

Deleting profiles

You can delete one or more profiles from the microscope when no longer required.

Note: Although multiple profiles can be deleted, by default, at least one profile must remain on the microscope.

Step 1. Select **Test Configuration** on the **Main Menu**.

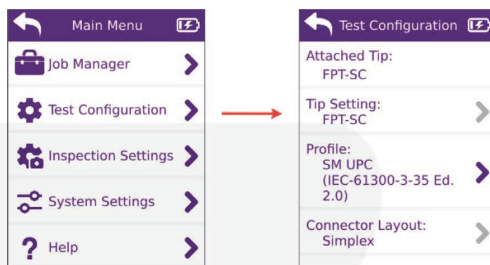

Step 2. Select **Profile** to access the list of available profiles, and then select **Edit**.

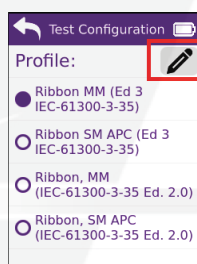

Step 3. On the **Edit** view, select the check box for each profile that you want to delete, and then select **Delete**.

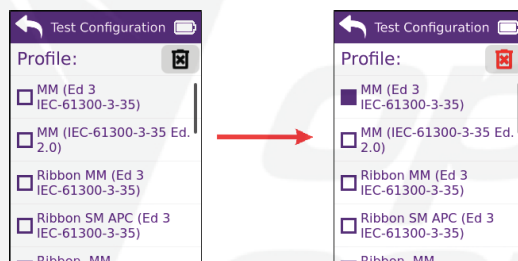

Step 4. Select **Yes** to confirm the operation and return to the list of available profiles.

— End —

Contact the professionals at Fiber Optic Center for a quote or to get more details.

focenter.com • 508-992-6464 | (800) 473-4237 • sales@focenter.com

23 Centre Street • New Bedford, MA 02740 USA

Product data subject to change without notice. FOC last update 1/27/2026.

Managing inspection settings

- Select **Inspection Settings** on the **Main Menu**.

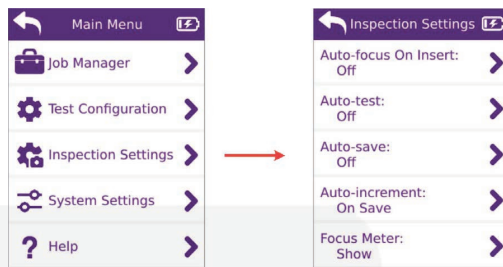

Table 3-3: Inspection settings

Settings	Description
Auto-focus On Insert	Automatically focus Live view when a fiber is mounted onto the fiber inspection tip. <ul style="list-style-type: none"> Off On (Default)
Auto-test	Automatically start a test when autofocus is performed. <ul style="list-style-type: none"> Off On Autofocus (Default)
Auto-save	Automatically save data when a Pass/Fail test is completed. <ul style="list-style-type: none"> Off (Default) If Pass If Fail Always
Auto-increment	Automatically increment the test label (ID) to the next available number on save. <ul style="list-style-type: none"> Off On Save (Default) On Save If Pass <p>Note: The Test ID label that appears on the Home screen shows the test ID to which test results will be assigned when saved either automatically or manually. To avoid overwriting test results already assigned to a test ID in the current job, enable the On Save option.</p>
Focus Meter	Focus meter visibility. <ul style="list-style-type: none"> Hide (Default) Show
Saved Image	Saved image quality: <ul style="list-style-type: none"> Standard Fidelity (Default) Compatibility Mode
MPO Pan Range	<ul style="list-style-type: none"> Standard (Default) Wide

Contact the professionals at Fiber Optic Center for a quote or to get more details.

focenter.com • 508-992-6464 | (800) 473-4237 • sales@focenter.com

23 Centre Street • New Bedford, MA 02740 USA

Managing system settings

- Select **System Settings** on the **Main Menu**.

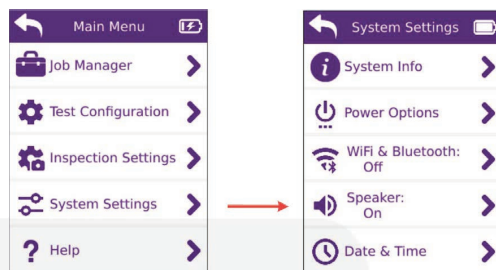

Table 3-4: System settings

Settings	Description
System Info	Software Version: Software version installed on microscope
	Serial Number: Microscope serial number
	Battery Info: <ul style="list-style-type: none"> • Status: Charging or Discharging • Level: Battery charge percent • Voltage: Voltage output
	Network Info <ul style="list-style-type: none"> • IP Address • WiFi Network Name • Bluetooth Address • MAC Address Note: Applies only to INX 700 Series Probe Microscopes with wireless connectivity.
	Regulatory Info: Regulatory compliance information. Tap to scroll through the available information.
	Open Source Licenses: List of OSS licenses
Power Options	Set power options for Auto Off, Auto Sleep, and Auto Screen Dim settings: <ul style="list-style-type: none"> • No • 1 min • 5 min (Default) • 10 min • 30 min
WiFi & Bluetooth Note: Applies only to INX 700 Series Probe Microscopes with wireless connectivity,	Wireless connectivity status: <ul style="list-style-type: none"> • Off (Default) • On
Speaker	Speaker status: <ul style="list-style-type: none"> • Off • On (Default; sound emitted when Pass/Fail test passes or fails.)

Contact the professionals at Fiber Optic Center for a quote or to get more details.

focenter.com • 508-992-6464 | (800) 473-4237 • sales@focenter.com

23 Centre Street • New Bedford, MA 02740 USA

Table 3-4: System settings (continued)

Settings	Description
Date & Time	System time and date settings: <ul style="list-style-type: none">• System Time• Date Format• Time Format
Language	System language options: <ul style="list-style-type: none">• English• Portuguese• Spanish• French• German• Simplified Chinese• Japanese
Options	Status of available options for the microscope: <ul style="list-style-type: none">• Multifiber: Enabled/Disabled• Bluetooth & WiFi: UpgradeableNote: Applies only to INX 700 Series Probe Microscopes with wireless connectivity.• SmartAccess Anywhere: Enabled/Disabled• Simplex: Enabled/Disabled
Factory Reset	Perform a factory reset, which deletes all user data and settings available on the microscope. Important: Ensure that all required data saved to the microscope is uploaded to the VIAVI Mobile Tech App before performing a factory reset.

Contact the professionals at Fiber Optic Center for a quote or to get more details.

focenter.com • 508-992-6464 | (800) 473-4237 • sales@focenter.com

23 Centre Street • New Bedford, MA 02740 USA

Updating the microscope software locally

You can update the microscope software locally by downloading the required software file from inx700.updatemyunit.net to a USB-C thumb drive and then connecting the thumb drive to the microscope.

Important: You can use the VIAVI Mobile Tech app to update the software on INX 700 Series microscopes that support wireless connectivity.

Notes:

- The software file is a compressed file (*.zip). Do not extract the file.
- The thumb drive must be formatted as either exFAT, FAT16, or FAT32.

Step 1. Ensure that the required software file is available on the thumb drive.

Step 2. Connect the thumb drive to the microscope.

The **USB** screen appears. When a software file is available on the thumb drive, the **Software Update** option (and the version number of the firmware) is available.

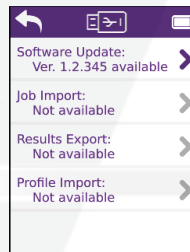

Step 3. Select **Update**, and then select **Yes** to confirm the operation.

The software update initiates. When the update is completed, a message appears to indicate that the operation was successful.

The microscope automatically powers OFF and then powers ON.

Step 4. Access **Systems Info** settings to confirm the software version (see “[Managing system settings](#)” on page 3-16).

— End —

Contact the professionals at Fiber Optic Center for a quote or to get more details.

focenter.com • 508-992-6464 | (800) 473-4237 • sales@focenter.com

23 Centre Street • New Bedford, MA 02740 USA



4 Pass/Fail tests and managing results

This section covers the following information:

- “Requirements for a Pass/Fail test” on page 4-2
- “Starting a Pass/Fail test” on page 4-3
- “Working with Pass/Fail test results” on page 4-4

*fiber
optic
center*

Contact the professionals at Fiber Optic Center for a quote or to get more details.

focenter.com • 508-992-6464 | (800) 473-4237 • sales@focenter.com

23 Centre Street • New Bedford, MA 02740 USA

Product data subject to change without notice. FOC last update 1/27/2026.

Requirements for a Pass/Fail test

Pass/Fail tests inspect fiber connectors against preconfigured pass criteria for the active analysis profile. For information about profiles, see [“Managing test configuration settings” on page 3-12](#).

Note: A Pass or Fail result applies to the entire connector. This means that if only one fiber in the array of a duplex or MPO connector fails to meet the preconfigured pass criteria, the test will return a Fail result for the entire connector. To achieve a Pass result, every fiber in the array must meet the pass criteria.

Table 4-1: Before you begin a Pass/Fail test

Ensure that...	See...
The correct fiber inspection tip for the test is properly installed on the microscope.	“Installing a fiber inspection tip” on page 2-6
The required fiber adapter is installed on the inspection tip and a clean fiber connector is mounted on the adapter.	“Mounting a fiber connector” on page 2-8
The analysis profile and tip settings are suitable for the Pass/Fail test.	“Managing test configuration settings” on page 3-12
The live image of the fiber end face is suitable for testing.	<ul style="list-style-type: none">• “Mounting a fiber connector” on page 2-8• “Navigating the Home screen” on page 3-2
The required inspection settings are enabled.	“Managing inspection settings” on page 3-15
The job where test results must be saved is set as the current job.	<ul style="list-style-type: none">• “Navigating the Home screen” on page 3-2• “Creating and managing jobs on the microscope” on page 3-5

Contact the professionals at Fiber Optic Center for a quote or to get more details.

focenter.com • 508-992-6464 | (800) 473-4237 • sales@focenter.com

23 Centre Street • New Bedford, MA 02740 USA

Starting a Pass/Fail test

Step 1. Review “Requirements for a Pass/Fail test” on page 4-2.

Step 2. Select **Start Test** on the Home screen, or long press the Action trigger.

The purple circulating LED lights while the test is performed. When the test is completed, the pass or fail message is briefly displayed, followed by the Inspected view of the fiber end face.

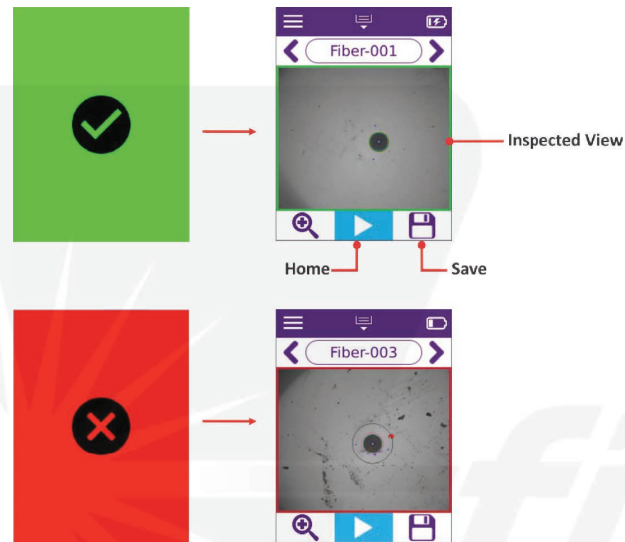

Note: If the **Auto-save** inspection setting is set to **If Pass** or **Always**, the test results are automatically saved to the current job, based on the enabled setting. The **Save** tool becomes unavailable after results are saved.

Step 3. Do any of the following:

- Use the **Magnification High/Low** tool to increase or decrease magnification of the fiber end face.
- Access analysis tools for the test result. See “Working with Pass/Fail test results” on page 4-4.
- Select **Save** (if required) to save the test results for later analysis.
- Select **Go To Previous** or **Go To Next** to scroll to the test ID for another tested fiber connector.

Note: If there are no test results assigned to the next test ID scrolled to, the **Home** screen automatically displays.

- Select **Home** to return to the **Home** screen.

— End —

Contact the professionals at Fiber Optic Center for a quote or to get more details.

focenter.com • 508-992-6464 | (800) 473-4237 • sales@focenter.com

23 Centre Street • New Bedford, MA 02740 USA

Working with Pass/Fail test results

You can access test data and available analysis tools immediately after a Pass/Fail test for any type of fiber connector.

Note: If the test results are saved, they can be recalled at a later time for analysis. See “Accessing saved Pass/Fail data” on page 4-6.

- Tap Inspected view to access analysis tools.

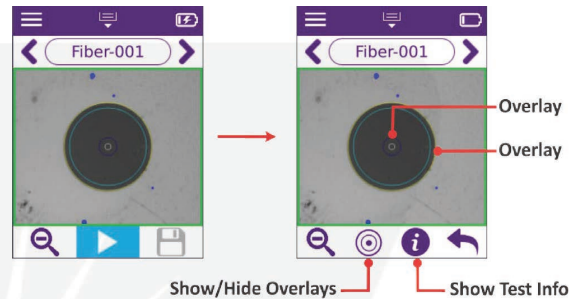

Overlays

Overlays on the captured image denote the fiber core diameter and the zones on the fiber end face as specified in the analysis profile used for the Pass/Fail test.

Overlays are displayed by default in Inspected view; however, you can show or hide them as needed by selecting **Show/Hide Overlays**.

Test Info

- Step 1. Select **Show Test Info** to access details of the Pass/Fail test, including Pass/Fail results per zone. Scroll to view all the information provided.

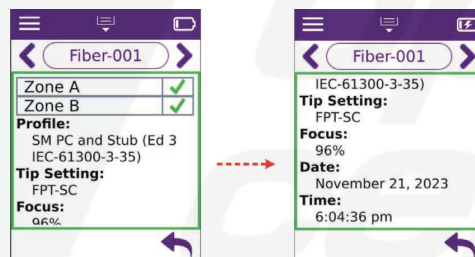

- Step 2. Optionally, select **Go To Previous** or **Go To Next** to scroll to the test ID for another tested fiber connector and view its test data.

Note: If there are no test results assigned to the next test ID scrolled to, the **Home** screen automatically displays.

- Step 3. Select **Back** to return to the previous screen.

— End —

Contact the professionals at Fiber Optic Center for a quote or to get more details.

focenter.com • 508-992-6464 | (800) 473-4237 • sales@focenter.com

23 Centre Street • New Bedford, MA 02740 USA

Product data subject to change without notice. FOC last update 1/27/2026.

Pass/Fail test results for MPO and duplex fiber connectors

Inspected views for MPO and duplex fiber connectors provide tools for navigating captured images.

Navigating MPO fiber connector test results

Inspected view for an MPO fiber connector shows the fiber array and the Pass/Fail results for each fiber in the array. For example, the MPO fiber connector shown in Figure 4-1 contains 12 fibers, and the pass/fail array shows that all fibers met the pass criteria (green).

To increase the magnification of Inspected view, tap the touchscreen or use the **Increase/Decrease Magnification** tool. To access the analysis tools (**Show/Hide Overlays**, **Show Test Info**) for a fiber, select a fiber number in the pass/fail array.

Figure 4-1: MPO fiber connector - Inspected view and test data for an individual fiber

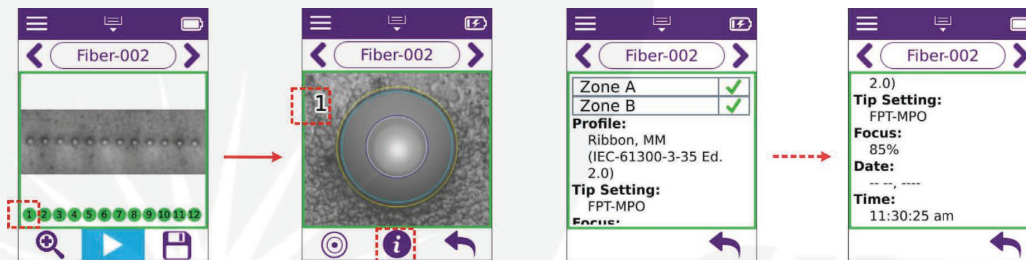

Navigating duplex fiber connector test results

Inspected view for a duplex fiber connector shows the left and right fibers and the Pass/Fail results for each fiber. For example, the left (L) and right (R) fibers in the duplex fiber connector shown in Figure 4-2 failed to meet all the pass criteria (red).

To access the analysis tools (**Show/Hide Overlays**, **Show Test Info**) for an individual fiber, tap the desired fiber.

Figure 4-2: Duplex fiber connector - Inspected view and test data for individual fiber

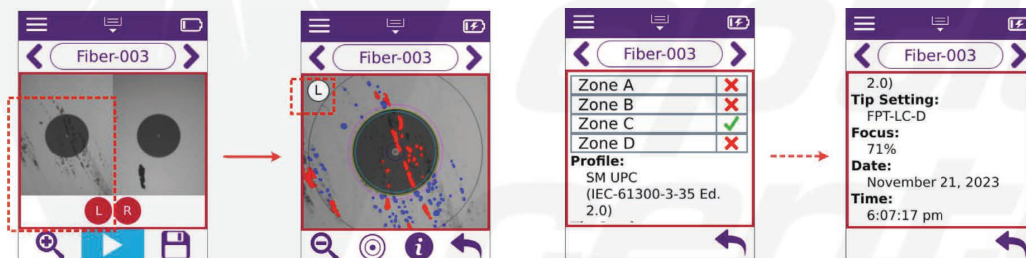

— End —

Contact the professionals at Fiber Optic Center for a quote or to get more details.

focenter.com • 508-992-6464 | (800) 473-4237 • sales@focenter.com

23 Centre Street • New Bedford, MA 02740 USA

Accessing saved Pass/Fail data

Step 1. Select **Job Manager** on the **Main Menu**.

Step 2. On the **Job Manager** screen, select a job ID in list.

The **Job Info** screen appears, indicating the number of Pass/Fail tests completed and saved to the job ID.

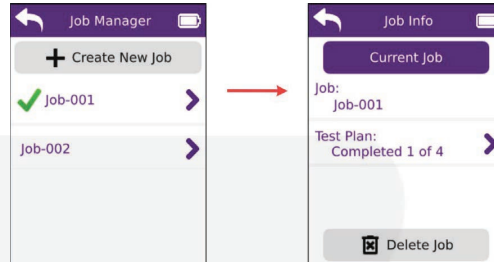

Step 3. If completed tests are available, select **Test Plan**, and then select a test ID in the list.

The Inspected view for the test appears. For more information, see “[Working with Pass/Fail test results](#)” on page 4-4.

Step 4. Optionally, select **Go To Previous** or **Go To Next** to scroll to the test ID for another tested fiber connector and view its test data.

Note: If there are no test results assigned to the next test ID scrolled to, the **Home** screen automatically displays.

Step 5. Short press the Action trigger to return to the **Home** screen.

— End —

Contact the professionals at Fiber Optic Center for a quote or to get more details.

focenter.com • 508-992-6464 | (800) 473-4237 • sales@focenter.com

23 Centre Street • New Bedford, MA 02740 USA

Product data subject to change without notice. FOC last update 1/27/2026.

Exporting saved test results

You can export saved test results to a USB-C thumb drive.

Important: You can use the VIAVI Mobile Tech app to export and share test results saved to an INX 700 Series microscope that supports wireless connectivity.

Notes:

- The thumb drive must be formatted as either exFAT, FAT16, or FAT32.
- The export operation will automatically export all test results saved to the microscope.

Step 1. Connect the thumb drive to the microscope.

The **USB** screen appears. When saved test results are available on the microscope, the **Results Export** option is available.

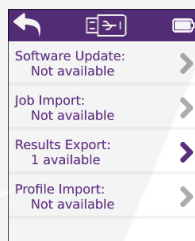

Step 2. Select **Export**, and then select **Yes** to confirm the operation.

Saved test results are exported to the thumb drive.

Step 3. Disconnect the thumb drive, and then access it on a PC to confirm that the results have been exported.

The export operation automatically adds one folder for each job that contains saved test results to the root of the thumb drive. Each folder contains one file (*.json) for each saved test result and a job report file.

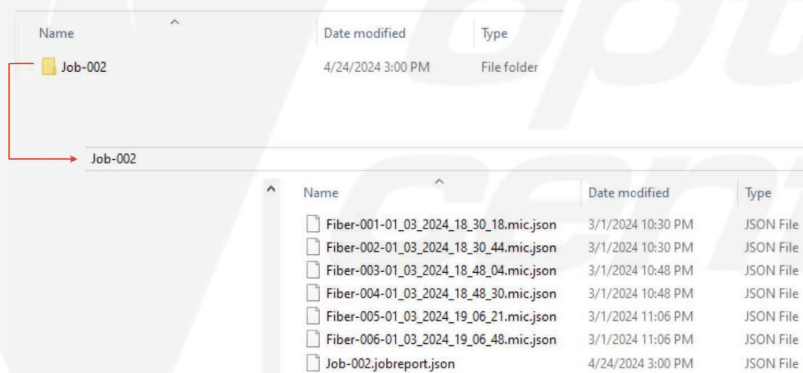

— End —

Contact the professionals at Fiber Optic Center for a quote or to get more details.

focenter.com • 508-992-6464 | (800) 473-4237 • sales@focenter.com

23 Centre Street • New Bedford, MA 02740 USA

Appendix A Regulatory compliance

This section covers the following information:

- “California Proposition 65” on page A-2
- “Federal Communications Commission (FCC)” on page A-2
- “Innovation, Science and Economic Development Canada” on page A-3
- “Korea Communications Commission” on page A-3
- “Product Environmental Compliance” on page A-4
- “EU REACH” on page A-5
- “EU Declaration of Conformity” on page A-5
- “EU Radio Equipment Directive” on page A-5
- “Additional standards compliance” on page A-5
- “China RoHS materials declaration” on page A-6

*fiber
optic
center*

Contact the professionals at Fiber Optic Center for a quote or to get more details.

focenter.com • 508-992-6464 | (800) 473-4237 • sales@focenter.com

23 Centre Street • New Bedford, MA 02740 USA

Product data subject to change without notice. FOC last update 1/27/2026.

California Proposition 65

California Proposition 65, officially known as the Safe Drinking Water and Toxic Enforcement Act of 1986, was enacted in November 1986 with the aim of protecting individuals in the state of California and the state's drinking water and environment from excessive exposure to chemicals known to the state to cause cancer, birth defects or other reproductive harm.

Federal Communications Commission (FCC)

When configured with wireless connectivity, this equipment has been tested and found to comply with the limits for a Class B digital device, pursuant to part 15 of the FCC Rules. These limits are designed to provide reasonable protection against harmful interference in a residential installation.

This equipment generates, uses and can radiate radio frequency energy and, if not installed and used in accordance with the instructions, may cause harmful interference to radio communications. However, there is no guarantee that interference will not occur in a particular installation. If this equipment does cause harmful interference to radio or television reception, which can be determined by turning the equipment off and on, the user is encouraged to try to correct the interference by one or more of the following measures:

- Reorient or relocate the receiving antenna.
- Increase the separation between the equipment and receiver.
- Connect the equipment into an outlet on a circuit different from that to which the receiver is connected.
- Consult the dealer or an experienced radio/TV technician for help.

The authority to operate this product is conditioned by the requirements that no modifications be made to the equipment unless the changes or modifications are expressly approved by VIAVI.

When configured with wireless connectivity, this device complies with part 15 of the FCC Rules. Operation is subject to the following two conditions:

1. This device may not cause harmful interference.
2. This device must accept any interference received, including interference that may cause undesired operation.

When configured with wireless connectivity, this product complies with 47 CFR Part 15 through use of a modular component authorized under a grant of certification: FCC ID: WUW-LWBPLUS.



CAUTION: RF Radiation Exposure

- This equipment complies with the FCC RF radiation exposure limits set forth for an uncontrolled environment.
- This transmitter must not be collocated or operated with any other antenna or transmitter.

Contact the professionals at Fiber Optic Center for a quote or to get more details.

focenter.com • 508-992-6464 | (800) 473-4237 • sales@focenter.com

23 Centre Street • New Bedford, MA 02740 USA

Innovation, Science and Economic Development Canada

This Class B digital apparatus complies with Canadian ICES-003.

This device contains licence-exempt transmitter(s)/receiver(s) that comply with Innovation, Science and Economic Development Canada's licence-exempt RSS(s). Operation is subject to the following two conditions:

1. This device may not cause interference.
2. This device must accept any interference, including interference that may cause undesired operation of the device.

Cet appareil numérique de la classe B est conforme à la norme NMB-003 du Canada.

Le présent appareil est conforme aux d'Innovation, Sciences et Développement économique Canada applicables aux appareils radio exempts de licence. L'exploitation est autorisée aux deux conditions suivantes:

1. l'appareil ne doit pas produire de brouillage,
2. l'utilisateur de l'appareil doit accepter tout brouillage radioélectrique subi, même si le brouillage est susceptible d'en compromettre le fonctionnement.

When configured with wireless connectivity, this product complies with relevant ISSED Canada Radio Standard Specifications (RSS) through use of the following modular component authorized under a grant of certification: IC: 9613A-LWBPLUS.

Lorsqu'il est configuré avec connectivité sans fil, ce produit est conforme aux spécifications des normes radioélectriques (RSS) pertinentes d'ISDE Canada grâce à l'utilisation du composant modulaire suivant autorisé en vertu de une délivrance de certification: IC: 9613A-LWBPLUS.



CAUTION: RF Radiation Exposure

- This equipment complies with ISSED Canada radiation exposure limits set forth for an uncontrolled environment.
- To comply with Canadian RF exposure requirements, this device and its antenna must not be collocated or operated in conjunction with any other antenna or transmitter.

ATTENTION: Exposition aux rayonnements RF

- Cet équipement est conforme aux limites d'exposition aux rayonnements RF d'ISDE Canada établies pour un environnement non contrôlé.
- Pour se conformer aux exigences de conformité RF canadienne l'exposition, cet appareil et son antenne ne doivent pas être co-localisés ou fonctionnant en conjonction avec une autre antenne ou transmetteur.

Korea Communications Commission

Korea Communications Commission (KCC)

이 기기는 업무용 환경에서 사용할 목적으로 적합성평가를 받은 기기로서 가정용 환경에서 사용하는 경우 전파 간섭의 우려가 있습니다

Contact the professionals at Fiber Optic Center for a quote or to get more details.

focenter.com • 508-992-6464 | (800) 473-4237 • sales@focenter.com

23 Centre Street • New Bedford, MA 02740 USA

Product Environmental Compliance

VIAVI is committed to compliance with all applicable laws and regulations controlling the use of hazardous substances in its products, as well as the disposal of equipment (including batteries) and waste packaging.



Contact the professionals at Fiber Optic Center for a quote or to get more details.

focenter.com • 508-992-6464 | (800) 473-4237 • sales@focenter.com

23 Centre Street • New Bedford, MA 02740 USA

Product data subject to change without notice. FOC last update 1/27/2026.

EU REACH

Article 33 of EU REACH regulation (EC) No 1907/2006 requires product suppliers to provide information when a substance included in the list of Substances of Very High Concern (SVHC) is present in a product above a certain threshold.

EU Declaration of Conformity

EU manufacturer Declaration of Conformity is shipped with the product and is also available on request.

EU Radio Equipment Directive

In accordance with Article 10.8 of the EU Radio Equipment Directive 2014/53/EU, the following table provides information on the frequency bands and the maximum RF transmit power of this product for sale in the EU.

Frequency Range (MHz)	Channels Used	Maximum Transmit Power (dBm)
2400-2483.5	1 to 13	19.98

When configured with wireless connectivity, this device is a 2.4 GHz wideband transmission system (transceiver), intended for use in all EU member states and EFTA countries, except in Italy and France where restrictive use applies.

In Italy the end-user should apply for a license at the national spectrum authorities in order to obtain authorization to use the device for setting up outdoor radio links and/or for supplying public access to telecommunications and/or network services.

When configured with wireless connectivity, this device may not be used for setting up outdoor radio links in France and in some areas the RF output power may be limited to 10 mW EIRP in the frequency range of 2454 to 2483.5 MHz. For detailed information, the end-user should contact the national spectrum authority in France.

Additional standards compliance

The equipment meets the following standards and requirements:

- Installation Category (Over voltage Category) II under IEC 60664-1
- Pollution Degree 2 Category under IEC 61010-1 Safety Requirements for Electrical Equipment for Measurement, Control, and Laboratory Use

Contact the professionals at Fiber Optic Center for a quote or to get more details.

focenter.com • 508-992-6464 | (800) 473-4237 • sales@focenter.com

23 Centre Street • New Bedford, MA 02740 USA

China RoHS materials declaration

The China RoHS materials declaration is shipped with the product and is also available on request.



Contact the professionals at Fiber Optic Center for a quote or to get more details.

focenter.com • 508-992-6464 | (800) 473-4237 • sales@focenter.com

23 Centre Street • New Bedford, MA 02740 USA

Product data subject to change without notice. FOC last update 1/27/2026.

Appendix B User Guide revision history

Revision	Date	Details
R004	June 2025	Updated section "Managing inspection settings"
R003	January 2025	<ul style="list-style-type: none">• Updated touchscreen images, tables, and related procedures throughout to reflect changes to the local graphical user interface and new functionality.• Changed document name to INX™ 700 Series Probe Microscope User Guide• Modified contents to reflect use of either the INX 760 or INX 750 Probe Microscope• Coverage of VIAVI Mobile Tech App moved to <i>Using the VIAVI Mobile Tech App with INX Series Probe Microscopes</i>, 22185265
002	June 2024	Updated the section "LED states"
001	April 2024	<ul style="list-style-type: none">• Added the following sections:<ul style="list-style-type: none">• "Importing job files"• "Exporting saved test results"• "Updating the INX 760 microscope software locally"• Updated the following sections:<ul style="list-style-type: none">• "INX 760 microscope Home screen menus and tools"• "INX 760 microscope System settings"• "Mounting a fiber connector"• "Pass/Fail test results for MPO and duplex fiber connectors"• "INX 760 Files"
000	December 2023	This document is released.

Contact the professionals at Fiber Optic Center for a quote or to get more details.

focenter.com • 508-992-6464 | (800) 473-4237 • sales@focenter.com

23 Centre Street • New Bedford, MA 02740 USA

Product data subject to change without notice. FOC last update 1/27/2026.